

BENELUX

Super 60

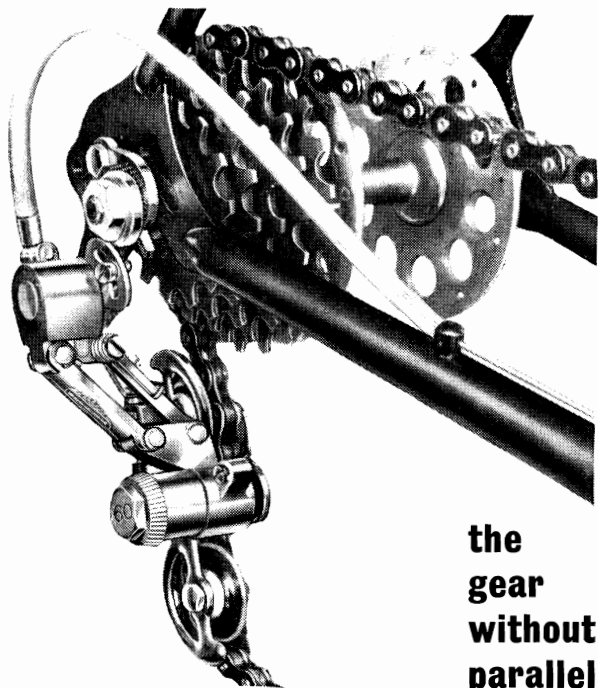

**the
gear
without
parallel**

All "Super 60" Gears are supplied already set and correctly tensioned to suitable chain length normally used on such types of derailleurs. We propose, for simplicity's sake to deal only with certain adjustments for which the need may arise.

N.B.—Sprocket Range 13T—26T on Freewheel.

4-tooth difference on Chainwheel—complete overall range 17T.

4-SPEED $\frac{3}{32}$ " Codeword—"SUFOR"

5-SPEED $\frac{3}{32}$ " Codeword—"SUFIV"

Fitting Instructions and Spares

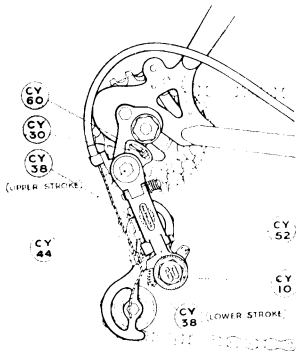

FIG. 1.

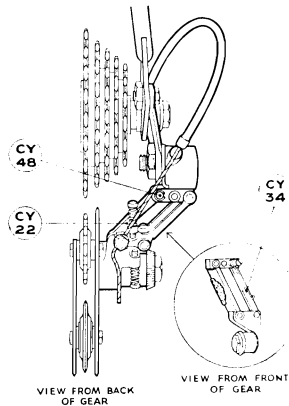
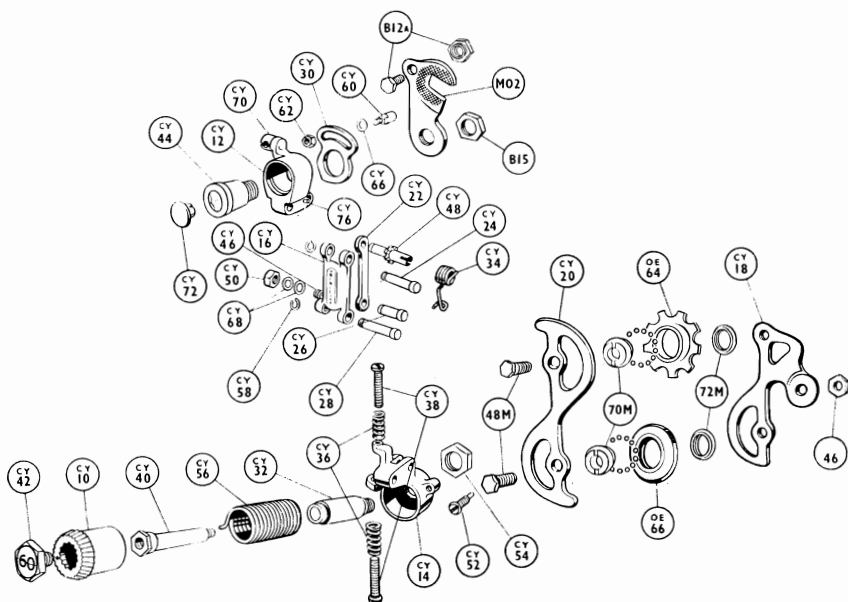

FIG. 2.

1. Fit Gear to Fork End.
2. Line up the 9-tooth Jockey Sprocket with Top Gear Cog by means of Lower Stroke Adjusting Screw (Ref. CY. 38) Fig. 1, making sure that the Derailing Cage is parallel with the Freewheel. IT IS IMPORTANT THAT THE GEAR DOES NOT APPEAR BENT OR TWISTED.

NOTE: Should the gear require setting, insert long section of Allen Key Setting Tool (Ref. CY.74) into Hexagon Hole of Swivel Pin (Ref. CY.44) and set correctly.

3. Fit Outer Casing and Inner Wire.
4. Correct chain length; fit the chain into derailing cage as in Fig. 1, derail chain on to low gear and set in correct position by means of Upper Stroke Adjusting Screw, see Fig. 1; set angular position of gear by means of Stop (Ref. CY60) in elongated slot in Stop Plate (Ref. CY.30) so that the chain will give one complete link (i.e. 3 rivets) from where the chain leaves the low gear cog to where it meets the 9-tooth Jockey Sprocket. Derail chain back on to top gear cog to ensure maximum wrap round of chain on sprockets. An extra link in the chain may be required or the angular position of the gear adjusted. THIS CHECK IS IMPORTANT AS IT ENSURES THAT THE CHAIN WILL NOT JUMP OR SLIP, EVEN IF THE GEAR IS INSUFFICIENTLY TENSIONED.
5. The radial tension of the derailing cage is restricted by Stop Screw (Ref. CY52). Do not remove this screw as restricted movement of the cage is to facilitate wheel removal.
6. Slow derailing action on to top gear cog is due to loss of tension. Detach leg of Arm Return Spring (Ref. CY.34) Fig. 2 from Rear Link (Ref. CY.22). Remove circlip from Spring Tension Shaft (Ref. CY.48). Withdraw shaft sufficiently for notch to clear Peg (Ref. CY.76). Turn shaft clockwise so that the next notch will locate on peg. Replace spring and circlip.
7. Should the Control Wire break, until replaced it is still possible to ride machine in any one gear. Mount chain on the cog selected and set Lower Stroke Adjusting Screw to secure this adjustment.



GEAR SPARES

Ref. No.

- CY10** Tension Barrel
- CY12** Upper Pivot Body
- CY14** Tension Body
- CY16** Front Arm
- CY18** Rear Guide Plate
- CY20** Front Guide Plate
- CY22** Rear Link
- CY24** Front Arm Upper Pin
- CY26** Rear Arm Upper Pin
- CY28** Front Arm Lower Pin
- CY30** Adj. Stop Plate
- CY32** Sleeve
- CY34** Arm Return Spring
- CY36** Friction Spring
- CY38** Stroke Adj. Screw
- CY40** Shaft
- CY42** Retaining Screw
- CY44** Swivel Pin
- CY46** Pinch Bolt
- CY48** Spring Tension Shaft
- CY50** Pinch Bolt Nut

Ref. No.

- CY52** Stop Screw
- CY54** Sleeve Ret. Nut
- CY56** Chain Tension Spring
- CY58** Circlip
- CY60** Arm Stop Pin
- CY62** 3BA Nut
- CY66** Stop Pin Washer
- CY68** Pinch Bolt Washer
- CY70** Cable Stop
- CY72** Button
- CY76** Spring Ret. Peg
- B12a** Rosa Stop Guide and Pin
- MO2** Arm Bracket
- B15** Nut
- 46** Shaft Nut
- 48M** Pulley Pin
- 72M** Tapped Cone
- OE64** Sprocket
- OE66** Roller
- 70M** Screwed Cone
- 64C** Sprocket Complete
- 66C** Roller Complete

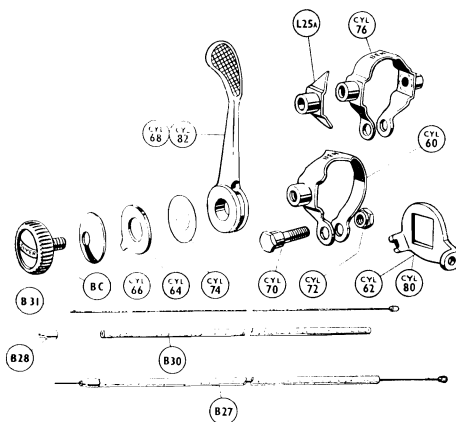

Ref. CY. 78



Ref. CY74 SETTING
TOOL

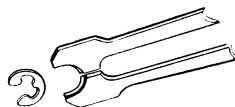

CIRCLIP APPLICATOR
For easy assembly of Circlip

LEVER SPARES

Ref. No.

- CYL60** Lever Clip with Boss
- CYL62** R. Hd. Back Plate
- CYL64** Friction Plate
- CYL66** Friction Spring Cover
- CYL68** R. Hd. Control Lever
- CYL70** Lever Clip Screw
- CYL72** Lever Clip Nut
- CYL74** Fibre Washer
- BC** Control Lever Damper
- CYL76** Double Lever Cup with Boss
- CYL80** L. Hd. Back Plate

Ref. No.

- CYL82** L. Hd. Control Lever
- CYL84** R.Hd. Control Lever Assy.
- CYL86** Double Control Lever Assy.
- L25A** Brazed-on Type
- B27** Transmission Complete
- B28** Cable Bell Ferrule
- B30** Outer Casing
- B31** Inner Wire only
- CY74** Setting Tool
- CY78** Circlip Applicator