

Cyclo **BENELUX**

new **SPORT P2**

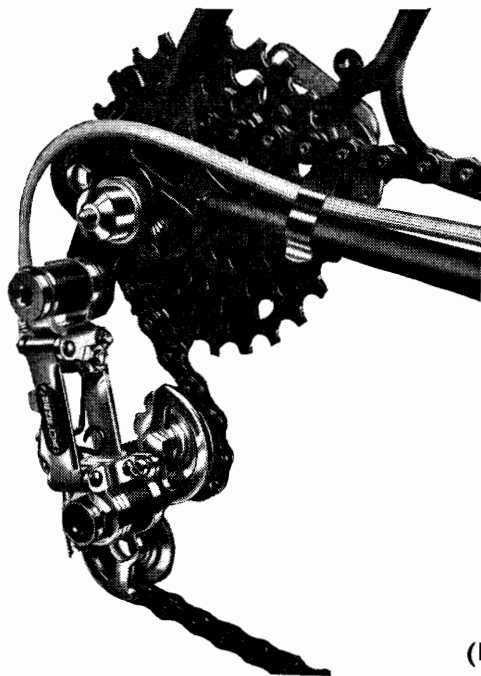

PRICE
45/-
(less Freewheel)



Incorporating all the vital points of the best parallelogram type of gear in simplified form, the Benelux 'Sport P2' has been proven in many road races and is destined to become Britain's top favourite. Universal for 3, 4 and 5 speeds the 'Sport P2' is, of course, backed by Cyclo 24 service and Guarantee.

Specify the Benelux 'Sport P2' for your new machine

Made in England by

Cyclo Gear Co. Ltd., Aston, Birmingham, 6

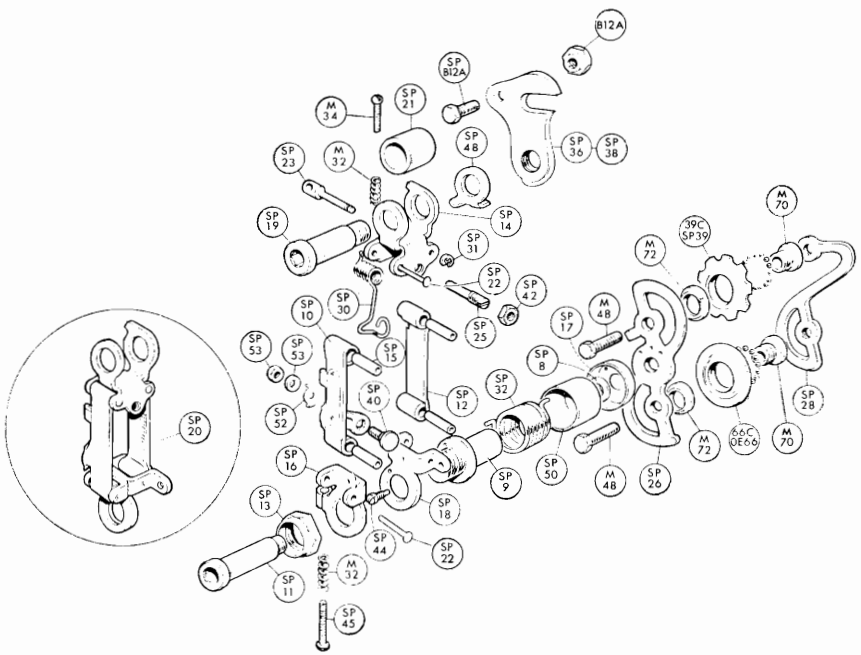

Ref. No.	GEAR SPARES	s.	d.
SP.8	Spacing Washer	-	3
SP.9	Sleeve	-	2 9
SP.10	Front Arm	-	5 0
SP.11	System Shaft	-	3 4
SP.12	Rear Arm	-	3 0
SP.13	Sleeve Nut	-	1 0
SP.14	Top Pivot Bracket	-	3 6
SP.15	Pivot Bush	each	2
SP.16	Lower Front Pivot Bracket	-	2 6
SP.17	Spring Cup	-	6
SP.18	Lower Rear Pivot Bracket	-	2 0
SP.19	Anchor Pin	-	3 2
SP.20	Linkage Assembly	-	15 0
SP.21	Distance Bush	-	8
SP.22	Rivet	each	1
SP.23	Cable Stop Pin	-	6
SP.25	Spring Retaining Shaft	-	5
SP.26	Front Guide Plate	-	6 0
SP.28	Rear Guide Plate	-	4 6
SP.30	Arm Return Spring	-	1 3
SP.31	Circlip	-	1
SP.32	Tension Spring	-	1 1
SP.36	$\frac{3}{8}$ " Anchor Plate	-	3 0
SP.38	$\frac{5}{16}$ " Anchor Plate	-	3 0
SP.39	9 tooth Jockey Sprocket	-	2 9
SP.40	Cable Clamp Bolt	-	10
SP.42	Lock Nut Spring Ret., Shaft	-	2
SP.44	Stop Screw	-	5
SP.45	Stroke Adj., Screw	-	3
SP.48	Anchor Plate Stop Washer	-	9
SP.50	Tension Spring Cover	-	6
SP.52	Cable Clamp Washer	-	4
SP.53	Cable Nut and Washer	-	5
32M	Friction Spring	each	3
34M	Stroke Adj., Screw	-	3



CY/46/T. Flat Spanner - 1/3 each



SP/74 Setting Tool 1/6 each

Ref. No.	GEAR SPARES (continued)	s. d.
B12A	Rosa Stop Guide and Pin - - - - -	5
48M	Pulley Pin - - - - - each	6
70M	Screwed Cone - - - - - each	2 1
72M	Tapped Cone - - - - - each	1 7
OE66	Tension Pulley - - - - -	2 2
39C	Sprocket Complete - - - - -	4 4
66C	Roller Complete - - - - -	3 10
	System Only - - - - -	35 0

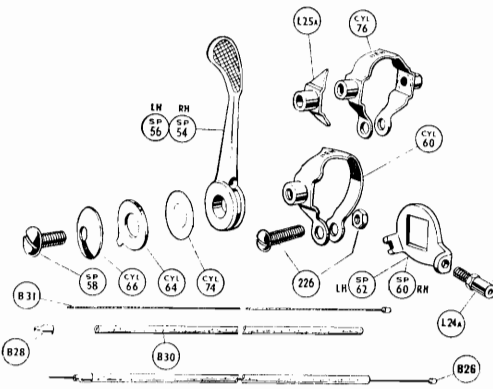

CY/62/T. Tubular Spanner 5/- each

Ref. No.	LEVER SPARES	s. d.
SP.54	R.H. Control Lever - - - - -	3 6
SP.56	L.H. Control Lever - - - - -	3 6
SP.58	Lever Friction Screw - - - - -	2
SP.60	R.H. Back Plate - - - - -	9
SP.62	L.H. Back Plate - - - - -	9
CYL.60	Lever Clip - - - - -	1 10
CYL.76	Double Lever Clip - - - - -	3 0
L.26	Clip Bolt and Nut - - - - -	4
CYL.64	Friction Plate - - - - -	6
CYL.66	Friction Cover Spring - - - - -	6
CYL.74	Fibre Washer - - - - -	2
B.26	Transmission Complete - - - - -	3 2
B.28	Bell Ferrule - - - - -	2
B.30	Outer Casing - - - - -	1 7
B.31	Inner Wire Only - - - - -	1 1
L.25A	Braze on Boss - - - - -	1 1
L.24A	Cable Adjuster - - - - -	4
SP.72	Cable Lever Assembly less Cable - - - - -	8 0

MADE IN ENGLAND

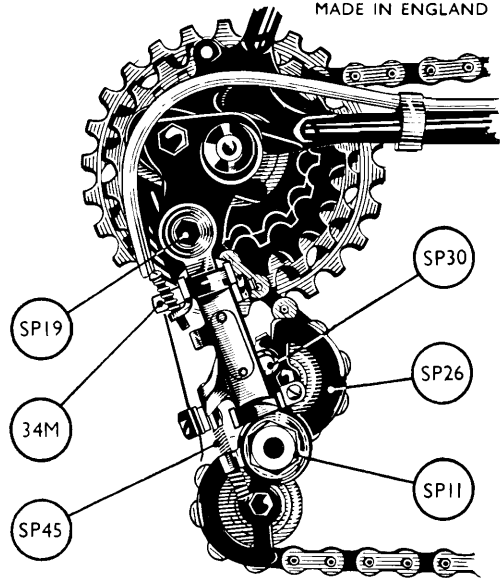

BENELUX

'SPORT P2'

FITTING

INSTRUCTIONS

1 Ensure that the gear is fitted in line with Chainwheel and that Swivel Pin Screw (SP19) is locked tight.

2 Be certain that the chain is long enough to allow using the largest chainwheel ring with the largest freewheel cog.

3 Adjust the two screws (34M) and (SP45) so that the chain cannot jump from the outside cogs of the freewheel when changing gear.

4 If freewheel is too near the spokes, fit a spacing washer behind the freewheel.

5 To give more or less tension to the chain, unscrew System Shaft (SP11) from Front Guide Plate (SP26), remove Spring End to another hole and re-tighten System Shaft (SP11).

N.B.—Should the Control Wire break, until replaced it is still possible to ride machine in any one gear by disengaging Spring (SP30).

The Cyclo Gear Co. Ltd., is not responsible for any inconvenience or damage caused by not having followed the above recommendations.